



YOTI N.N. & ASSOCIATES, INC (YNN)
Industrial Hygiene and Environmental Services

October 27, 2024

Mr. Derek Kwon
Montgomery County Public School
Division of Sustainability and Compliance
8301 Turkey Thicket Drive,
Gaithersburg, Maryland 20879

RE: Fiber-in-air Sampling – Joann Leleck Elementary School

Dear Mr. Kwon:

Yoti N. N. & Associates, Inc. (YNN) performed a fiber-in-air sampling of Joann Leleck Elementary school (Site) per Montgomery County Public School (MCPS), Division of Sustainability and Compliance (DSC) request. The Site is located at 710 Beacon Road in Silver Spring, Maryland. The sampling request was made pursuant of building fire resulting in total collapse of the building structure. YNN mobilized to the Site and has been conducting air sampling, beginning on September 25, 2024 and will continue to collect environmental air samples until instructed otherwise.

The report present is for the fiber-in-air samples collected on October 21, 2024 through October 27, 2024.

YNN's Industrial Hygienist, Mr. John Ndanga, conducted the fiber-in-air sampling. The samples were collected along the fence that has been erected around the demolished building structure.

YNN collected the Phase Contrast Microscopy (PCM) air samples using low-volume air sampling pumps which were calibrated on Site with a rotameter. Collected air samples were analyzed using Phase Contrast Microscopy (PCM) in accordance with the National Institute for Occupational Safety and Health (NIOSH) Method 7400. PCM analysis was performed by assigned Industrial Hygienists who have completed the NIOSH 582 equivalency course.

Refer to the attached field data sheets and drawing for detailed sample locations and air sampling results. Based on the air sampling data collected, there is no evidence that elevated background fiber levels exist within the area of concern at Joann Leleck Elementary School.

YNN continues to perform fiber-in-air sampling at the Site.

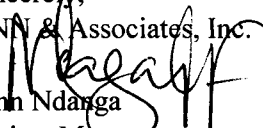
Sincerely,
YNN & Associates, Inc.

John Ndanga
Project Manager



YOTI N.N. & ASSOCIATES, INC (YNN)

Industrial Hygiene and Environmental Services

Page: 1 of 1

DAILY LOG SHEET

Date: 10/21/2024

Job Name: Joann Leleck ES

Time	Remarks
6:30	YNN's field IH arrived at Joann Leleck Elementary school (Site) to perform environmental (fiber-in-air) sampling following the fire incident which resulted in almost total colaps of the structure. The Site is located at 710 Beacon Road in Silver Spring, Maryland.
	Mr. Chris Marro (Sr. General Superintendent) with Gilbane informed IH that demo crew will continue to separate scrap metal, bricks and concrete from demo debris and also knocking down South Classrooms. Demo company is Bowen & Kron.
7:10	IH calibrated low volume air samplers with a rotameter and commenced environmental air sampling along the erected fence surrounding the demolished building structure.
	Air samplers were strategically positioned to capture air quality in different sections of the Site.
	The excavators will continue to demo South Classrooms and continue loading up separate dumpsters with scrap metal, concrete/bricks and demo debris. A worker will continue to utilize a water truck with a water cannon for dust suppression to minimize airborne particles during the demo operation.
	A-L Abatement will continue to lineup 40 foot dumpsters with 6 mil poly as the dump trucks pull up. Once lined up with poly, the demo crew loads them up with contaminated waste and hauled away to the landfill for proper disposal.
10:45	IH performed a walk through of the area. The demo operators continued to perform demo of South Classrooms and loading up dumpsters. Dust suppression via water cannon continues.
	Air samplers observed to be running properly. Dump trucks continued to haul away dumpster loads of contaminated debris separated from brick/concrete and scrap metal.
13:30	IH performed a walk through of the area and checked on the air samplers. Air samplers were observed running well. Demo operation observed to be moving along without any problems.
	Dust suppression with water cannon to minimize airborne particles during demo continues.
	Six forty foot dumpsters where pulled away from the Site loaded with contaminated debris to the landfill for proper disposal. The debris was wetted down with the water cannon before being loaded into the dumpsters and hauled away to the landfill for proper disposal.
14:00-14:30	IH collected air samples and samplers and exited the Site.
18:00-19:30	IH prepared air samples and performed air sample analysis via PCM. All air samples were below 0.01 f/cc.



YOTI N.N. & ASSOCIATES, INC (YNN)
Industrial Hygiene and Environmental Services

AIR SAMPLE DATA SHEET

Client: MCPS **Project Name:** Joann Leleck Elementary School
Work Area: Along the Fence **Date:** 10/21/2024

Sample NO.	Location / Code Relation to work	FLOW RATE		Time		Total Time	Total Volume	Fibers	Fibers CC
		Start	End	On	Off				
102124-1	Environmental-Main Entrance on Fence	3	3	7:10	14:00	410	1230	3	< 0.01
102124-2	Environmental-Facing White Apartments	3	3	7:11	14:01	410	1230	2	< 0.01
102124-3	Environmental-Facing House 705	3	3	7:12	14:05	413	1239	4	< 0.01
102124-4	Environmental-Facing Brown Apts.	3	3	7:15	14:07	412	1236	6.5	< 0.01
102124-5	Environmental-Facing Brown Apts.	3	3	7:16	14:08	412	1236	5.5	< 0.01
102124-6	Environmental-Facing St. Camillus	3	3	7:21	14:12	411	1233	4.5	< 0.01
102124-7	Environmental-Facing St. Camillus	3	3	7:22	14:14	412	1236	3.5	< 0.01
102124-8	Environmental-Facing Playground	3	3	7:24	14:16	412	1236	5	< 0.01
102124-9	Environmental-Facing Playground	3	3	7:26	14:17	411	1233	6	< 0.01
102124-10	Environmental-Facing Gym	3	3	7:29	14:19	410	1230	5.5	< 0.01
102124-11	Environmental-Facing Gym	3	3	7:30	14:20	410	1230	4	< 0.01
102124-12	Environmental-Facing Field	3	3	7:33	14:22	409	1227	6	< 0.01
Abbreviations:									
	PRE - Pre-Abatement Sampling	BLK - Blank		NFO - No Fibers Observed					
	OGBA - Outside Glove Bag Area	IWA - Inside Work Area		Post - Final Clearance monitoring					
	IGBA - Inside Glove Bag Area	OWA - Outside Work Area		AMB - Ambient					
	PRS - Personal Sample	OBT - Outside Barrier Tape		CB - Critical Barrier					
	IBT - Inside Barrier Tape								

Analyst: John Ndanga
Date: 10/21/2024



YOTI N.N. & ASSOCIATES, INC (YNN)
 Industrial Hygiene and Environmental Services

AIR SAMPLE DATA SHEET

Client: MCPS **Project Name:** Joann Leleck Elementary School
Work Area: Along the Fence **Date:** 10/21/2024

Sample NO.	Location / Code Relation to work	FLOW RATE		Time		Total Time	Total Volume	Fibers	Fibers CC
		Start	End	On	Off				
102124-13	Environmental-Facing Field	3	3	7:35	14:23	408	1224	9	< 0.01
102124-14	BLK								NFO
102124-15	BLK								NFO
Abbreviations: PRE - Pre-Abatement Sampling OGBA - Outside Glove Bag Area IGBA - Inside Glove Bag Area PRS - Personal Sample IBT - Inside Barrier Tape BLK - Blank IWA - Inside Work Area OWA - Outside Work Area OBT - Outside Barrier Tape NFO - No Fibers Observed Post - Final Clearance monitoring AMB - Ambient CB - Critical Barrier									

Analyst: John Ndanga
Date: 10/21/2024



YOTI N.N. & ASSOCIATES, INC (YNN)

Industrial Hygiene and Environmental Services

Page: 1 of 1

DAILY LOG SHEET

Date: 10/22/2024

Job Name: Joann Leleck ES

Time	Remarks
6:30	YNN's field IH arrived at Joann Leleck Elementary school (Site) to perform environmental (fiber-in-air) sampling following the fire incident which resulted in almost total colaps of the structure. The Site is located at 710 Beacon Road in Silver Spring, Maryland.
	Mr. Chris Marro (Sr. General Superintendent) with Gilbane informed IH that demo crew will continue to separate scrap metal, bricks and concrete from demo debris and also knocking down South Classrooms. Demo company is Bowen & Kron.
7:15	IH calibrated low volume air samplers with a rotameter and commenced environmental air sampling along the erected fence surrounding the demolished building structure.
	Air samplers were strategically positioned to capture air quality in different sections of the Site.
	The excavators will continue to demo South Classrooms and continue loading up separate dumpsters with scrap metal, concrete/bricks and demo debris. Two workers continue to utilize a water truck with a water cannon for dust suppression to minimize airborne particles during the demo operation. The demo crew will continue to wet down the contaminated demo debris.
	A-L Abatement will continue to lineup 40 foot dumpsters with 6 mil poly as the dump trucks pull up. Once lined up with 6 mil poly, the demo crew loads them up with contaminated waste and hauled away to the landfill for proper disposal.
11:30	IH performed a walk through of the area. The demo operators continued to perform demo of South Classrooms and loading up dumpsters. Dust suppression via water cannon continues.
	Air samplers observed to be running properly. Dump trucks continued to haul away dumpster loads of contaminated debris separated from brick/concrete and scrap metal.
13:00	IH performed a walk through of the area and checked on the air samplers. Air samplers were observed running well. Demo operation observed to be moving along without any problems.
	Dust suppression with water cannon to minimize airborne particles during demo continues.
	Six forty foot dumpsters where pulled away from the Site loaded with contaminated demo debris to the landfill for proper disposal. The debris was wetted down with the water cannon before being loaded into the dumpsters and hauled away to the landfill for proper disposal.
14:00-14:30	IH collected air samples and samplers and exited the Site.
18:10-19:40	IH prepared air samples and performed air sample analysis via PCM. All air samples were below 0.01 f/cc.



AIR SAMPLE DATA SHEET

Client: MCPS **Project Name:** Joann Leleck Elementary School
Work Area: Along the Fence **Date:** 10/22/2024

Sample NO.	Location / Code Relation to work	FLOW RATE		Time		Total Time	Total Volume	Fibers	Fibers CC
		Start	End	On	Off				
102224-1	Environmental-Main Entrance on Fence	3	3	7:15	14:00	405	1215	4	< 0.01
102224-2	Environmental-Facing White Apartments	3	3	7:16	14:01	405	1215	5.5	< 0.01
102224-3	Environmental-Facing House 705	3	3	7:18	14:03	405	1215	4.5	< 0.01
102224-4	Environmental-Facing Brown Apts.	3	3	7:20	14:06	406	1218	4	< 0.01
102224-5	Environmental-Facing Brown Apts.	3	3	7:21	14:07	406	1218	5.5	< 0.01
102224-6	Environmental-Facing St. Camillus	3	3	7:27	14:10	403	1209	4	< 0.01
102224-7	Environmental-Facing St. Camillus	3	3	7:28	14:11	403	1209	3.5	< 0.01
102224-8	Environmental-Facing Playground	3	3	7:31	14:14	403	1209	6	< 0.01
102224-9	Environmental-Facing Playground	3	3	7:32	14:15	403	1209	5.5	< 0.01
102224-10	Environmental-Facing Gym	3	3	7:35	14:19	404	1212	7	< 0.01
102224-11	Environmental-Facing Gym	3	3	7:36	14:20	404	1212	8	< 0.01
102224-12	Environmental-Facing Field	3	3	7:39	14:24	405	1215	6	< 0.01
Abbreviations:									
	PRE - Pre-Abatement Sampling	BLK - Blank		NFO - No Fibers Observed					
	OGBA - Outside Glove Bag Area	IWA - Inside Work Area		Post - Final Clearance monitoring					
	IGBA - Inside Glove Bag Area	OWA - Outside Work Area		AMB - Ambient					
	PRS - Personal Sample	OBT - Outside Barrier Tape		CB - Critical Barrier					
	IBT - Inside Barrier Tape								

Analyst: John Ndanga
Date: 10/22/2024



YOTI N.N. & ASSOCIATES, INC (YNN)

Industrial Hygiene and Environmental Services

AIR SAMPLE DATA SHEET

Client: MCPS Project Name: Joann Leleck Elementary School
Work Area: Along the Fence Date: 10/22/2024

Sample NO.	Location / Code Relation to work	FLOW RATE		Time		Total Time	Total Volume	Fibers	Fibers CC
		Start	End	On	Off				
102224-13	Environmental-Facing Field	3	3	7:40	14:25	405	1215	10.5	< 0.01
102224-14	BLK								NFO
102224-15	BLK								NFO

Abbreviations: PRE - Pre-Abatement Sampling
OGBA - Outside Glove Bag Area
IGBA - Inside Glove Bag Area
PRS - Personal Sample
IBT - Inside Barrier Tape

BLK - Blank
IWA - Inside Work Area
OWA - Outside Work Area
OBT - Outside Barrier Tape

NFO - No Fibers Observed
Post - Final Clearance monitoring
AMB - Ambient
CB - Critical Barrier

Analyst: John Ndanga
Date: 10/22/2024



YOTI N.N. & ASSOCIATES, INC (YNN)

Industrial Hygiene and Environmental Services

Page: 1 of 1

DAILY LOG SHEET

Date: 10/23/2024

Job Name: Joann Leleck ES

Time	Remarks
6:30	YNN's field IH arrived at Joann Leleck Elementary school (Site) to perform environmental (fiber-in-air) sampling following the fire incident which resulted in almost total colaps of the structure. The Site is located at 710 Beacon Road in Silver Spring, Maryland.
	Mr. Chris Marro (Sr. General Superintendent) with Gilbane informed IH that demo crew will continue to separate scrap metal, bricks and concrete from demo debris and also knocking down South Classrooms. Demo company is Bowen & Kron.
7:20	IH calibrated low volume air samplers with a rotameter and commenced environmental air sampling along the erected fence surrounding the demolished building structure.
	Air samplers were strategically positioned to capture air quality in different sections of the Site.
	The excavators will continue to demo South Classrooms and continue loading up separate dumpsters with scrap metal, concrete/bricks and demo debris. Two workers continue to utilize a water truck with a water cannon for dust suppression to minimize airborne particles during the demo operation. The demo crew will continue to wet down the contaminated demo debris.
	A-L Abatement will continue to lineup 40 foot dumpsters with 6 mil poly as the dump trucks pull up. Once lined up with 6 mil poly, the demo crew loads them up with contaminated waste and hauled away to the landfill for proper disposal.
11:00	IH performed a walk through of the area. The demo operators continued to perform demo of South Classrooms and loading up dumpsters. Dust suppression via water cannon continues.
	Air samplers observed to be running properly. Dump trucks continued to haul away dumpster loads of contaminated debris separated from brick/concrete and scrap metal. The scrap metals are also being hauled away for recycling.
13:00	Demo operation observed to be moving along without any problems. Dust suppression with water cannon to minimize airborne particles during demo continues. A total of six forty foot dumpsters where pulled away from the Site loaded with contaminated demo debris to the landfill for proper disposal. The debris was wetted down with the water cannon before being loaded into the dumpsters and hauled away to the landfill for proper disposal.
14:00-14:30	IH collected air samples and samplers and exited the Site.
18:00-19:30	IH prepared air samples and performed air sample analysis via PCM. All air samples were below 0.01 f/cc.



YOTI N.N. & ASSOCIATES, INC (YNN)
Industrial Hygiene and Environmental Services

AIR SAMPLE DATA SHEET

Client: MCPS **Project Name:** Joann Leleck Elementary School
Work Area: Along the Fence **Date:** 10/23/2024

Sample NO.	Location / Code Relation to work	FLOW RATE		Time		Total Time	Total Volume	Fibers	Fibers CC
		Start	End	On	Off				
102324-1	Environmental-Main Entrance on Fence	3	3	7:20	14:00	400	1200	3	< 0.01
102324-2	Environmental-Facing White Apartments	3	3	7:21	14:01	400	1200	5	< 0.01
102324-3	Environmental-Facing House 705	3	3	7:23	14:03	400	1200	3.5	< 0.01
102324-4	Environmental-Facing Brown Apts.	3	3	7:26	14:06	400	1200	5	< 0.01
102324-5	Environmental-Facing Brown Apts.	3	3	7:27	14:07	400	1200	6.5	< 0.01
102324-6	Environmental-Facing St. Camillus	3	3	7:34	14:10	396	1188	6	< 0.01
102324-7	Environmental-Facing St. Camillus	3	3	7:35	14:11	396	1188	4.5	< 0.01
102324-8	Environmental-Facing Playground	3	3	7:37	14:14	397	1191	3.5	< 0.01
102324-9	Environmental-Facing Playground	3	3	7:38	14:15	397	1191	5	< 0.01
102324-10	Environmental-Facing Gym	3	3	7:40	14:19	399	1197	8	< 0.01
102324-11	Environmental-Facing Gym	3	3	7:41	14:20	399	1197	6.5	< 0.01
102324-12	Environmental-Facing Field	3	3	7:44	14:24	400	1200	6	< 0.01
Abbreviations:									
	PRE - Pre-Abatement Sampling	BLK - Blank			NFO - No Fibers Observed				
	OGBA - Outside Glove Bag Area	IWA - Inside Work Area			Post - Final Clearance monitoring				
	IGBA - Inside Glove Bag Area	OWA - Outside Work Area			AMB - Ambient				
	PRS - Personal Sample	OBT - Outside Barrier Tape			CB - Critical Barrier				
	IBT - Inside Barrier Tape								

Analyst: John Ndanga
Date: 10/23/2024



YOTI N.N. & ASSOCIATES, INC (YNN)

Industrial Hygiene and Environmental Services

AIR SAMPLE DATA SHEET

Client: MCPS
Work Area: Along the Fence
Project Name: Joann Leleck Elementary School
Date: 10/23/2024

Sample NO.	Location / Code Relation to work	FLOW RATE		Time		Total Time	Total Volume	Fibers	Fibers CC
		Start	End	On	Off				
102324-13	Environmental-Facing Field	3	3	7:45	14:25	400	1200	8.5	< 0.01
102324-14	BLK								NFO
102324-15	BLK								NFO

Abbreviations: PRE - Pre-Abatement Sampling
 OGBA - Outside Glove Bag Area
 IGBA - Inside Glove Bag Area
 PRS - Personal Sample
 IBT - Inside Barrier Tape
 BLK - Blank
 IWA - Inside Work Area
 OWA - Outside Work Area
 OBT - Outside Barrier Tape
 NFO - No Fibers Observed
 Post - Final Clearance monitoring
 AMB - Ambient
 CB - Critical Barrier

Analyst: John Ndanga
Date: 10/23/2024



YOTI N.N. & ASSOCIATES, INC (YNN)

Industrial Hygiene and Environmental Services

DAILY LOG SHEET

Date: 10/24/2024

Job Name: Joann Leleck ES

Time	Remarks
6:30	YNN's field IH arrived at Joann Leleck Elementary school (Site) to perform environmental (fiber-in-air) sampling following the fire incident which resulted in almost total colaps of the structure. The Site is located at 710 Beacon Road in Silver Spring, Maryland.
	Mr. Chris Marro (Sr. General Superintendent) with Gilbane informed IH that demo crew will continue to separate scrap metal, bricks and concrete from demo debris and also knocking down South Classrooms. Demo company is Bowen & Kron.
7:00	IH calibrated low volume air samplers with a rotameter and commenced environmental air sampling along the erected fence surrounding the demolished building structure.
	Air samplers were strategically positioned to capture air quality in different sections of the Site. The excavators will continue to demo portables and continue loading up separate dumpsters with scrap metal, concrete/bricks and demo debris. Two workers continue to utilize a water truck with a water cannon for dust suppression to minimize airborne particles during the demo operation. The demo crew will continue to wet down the contaminated demo debris and load into dumpster. A-L Abatement will continue to lineup 40 foot dumpsters with 6 mil poly as the dump trucks pull up. Once lined up with 6 mil poly, the demo crew loads them up with contaminated waste and hauled away to the landfill for proper disposal.
10:30	IH performed a walk through of the area. The demo operators continued to perform demo of portables and loading up dumpsters. Dust suppression via water cannon continues.
	Air samplers observed to be running properly. Dump trucks continued to haul away dumpster loads of contaminated debris separated from brick/concrete and scrap metal. The scrap metals are also being hauled away for recycling. Separation of contaminated debris from scrap metal continues. Demo operation observed to be moving along without any problems. Dust suppression with water cannon to minimize airborne particles during demo continues. A total of six forty foot dumpsters where pulled away from the Site loaded with contaminated demo debris to the landfill for proper disposal. The debris was wetted down with the water cannon before being loaded into the dumpsters and hauled away to the landfill for proper disposal.
14:00-14:28	IH collected air samples and samplers and exited the Site.
18:10-19:45	IH prepared air samples and performed air sample analysis via PCM. All air samples were below 0.01 f/cc.



YOTI N.N. & ASSOCIATES, INC (YNN)
Industrial Hygiene and Environmental Services

AIR SAMPLE DATA SHEET

Client: MCPS Project Name: Joann Leleck Elementary School
 Work Area: Along the Fence Date: 10/24/2024

Sample NO.	Location / Code Relation to work	FLOW RATE		Time		Total Time	Total Volume	Fibers	Fibers CC
		Start	End	On	Off				
102424-1	Environmental-Main Entrance on Fence	3	3	7:00	14:00	420	1260	4.5	< 0.01
102424-2	Environmental-Facing White Apartments	3	3	7:01	14:02	421	1263	6.5	< 0.01
102424-3	Environmental-Facing House 705	3	3	7:03	14:04	421	1263	5.5	< 0.01
102424-4	Environmental-Facing Brown Apts.	3	3	7:05	14:07	422	1266	7.5	< 0.01
102424-5	Environmental-Facing Brown Apts.	3	3	7:06	14:08	422	1266	9	< 0.01
102424-6	Environmental-Facing St. Camillus	3	3	7:15	14:12	417	1251	7.5	< 0.01
102424-7	Environmental-Facing St. Camillus	3	3	7:16	14:14	418	1254	8.5	< 0.01
102424-8	Environmental-Facing Playground	3	3	7:18	14:16	418	1254	5	< 0.01
102424-9	Environmental-Facing Playground	3	3	7:19	14:17	418	1254	6.5	< 0.01
102424-10	Environmental-Facing Gym	3	3	7:23	14:20	417	1251	9	< 0.01
102424-11	Environmental-Facing Gym	3	3	7:24	14:21	417	1251	7.5	< 0.01
102424-12	Environmental-Facing Field	3	3	7:27	14:23	416	1248	8.5	< 0.01
Abbreviations:									
	PRE - Pre-Abatement Sampling	BLK - Blank		NFO - No Fibers Observed					
	OGBA - Outside Glove Bag Area	IWA - Inside Work Area		Post - Final Clearance monitoring					
	IGBA - Inside Glove Bag Area	OWA - Outside Work Area		AMB - Ambient					
	PRS - Personal Sample	OBT - Outside Barrier Tape		CB - Critical Barrier					
	IBT - Inside Barrier Tape								

Analyst: John Ndanga
 Date: 10/24/2024



YOTT N.N. & ASSOCIATES, INC (YNN)
Industrial Hygiene and Environmental Services

AIR SAMPLE DATA SHEET

Client: MCPS **Project Name:** Joann Leleck Elementary School

Work Area: Along the Fence **Date:** 10/24/2024

Sample NO.	Location / Code Relation to work	FLOW RATE		Time		Total Time	Total Volume	Fibers	Fibers CC
		Start	End	On	Off				
102424-13	Environmental-Facing Field	3	3	7:20	14:26	426	1278	10	< 0.01
102424-14	BLK								NFO
102424-15	BLK								NFO
Abbreviations: PRE - Pre-Abatement Sampling BLK - Blank NFO - No Fibers Observed OGBA - Outside Glove Bag Area IWA - Inside Work Area Post - Final Clearance monitoring IGBA - Inside Glove Bag Area OWA - Outside Work Area AMB - Ambient PRS - Personal Sample OBT - Outside Barrier Tape CB - Critical Barrier IBT - Inside Barrier Tape									

Analyst: John Ndanga 10/24/2024



YOTI N.N. & ASSOCIATES, INC (YNN)

Industrial Hygiene and Environmental Services

DAILY LOG SHEET

Date: 10/25/2024

Job Name: Joann Leleck ES

Time	Remarks
6:30	YNN's field IH arrived at Joann Leleck Elementary school (Site) to perform environmental (fiber-in-air) sampling following the fire incident which resulted in almost total colaps of the structure. The Site is located at 710 Beacon Road in Silver Spring, Maryland.
	Mr. Chris Marro (Sr. General Superintendent) with Gilbane informed IH that demo crew will continue to separate scrap metal, bricks and concrete from demo debris and also knocking down South Classrooms. Demo company is Bowen & Kron.
7:12	IH calibrated low volume air samplers with a rotameter and commenced environmental air sampling along the erected fence surrounding the demolished building structure.
	Air samplers were strategically positioned to capture air quality in different sections of the Site. The excavators will continue to demo portables and continue loading up separate dumpsters with scrap metal, concrete/bricks and demo debris. Two workers continue to utilize a water truck with a water cannon for dust suppression to minimize airborne particles during the demo operation. The demo crew will continue to wet down the contaminated demo debris and load into dumpster. A-L Abatement will continue to lineup 40 foot dumpsters with 6 mil poly as the dump trucks arrive. Once lined up with 6 mil poly, the demo crew loads them up with contaminated waste and hauled away to the landfill for proper disposal.
11:15	IH performed a walk through of the area. The demo operators continued to perform demo of portables and loading up dumpsters. Dust suppression via water cannon continues.
	Air samplers observed to be running properly. Dump trucks continued to haul away dumpster loads of contaminated debris separated from brick/concrete and scrap metal. The scrap metals are also being hauled away for recycling. Separation of contaminated debris from scrap metal continues. Demo operation observed to be moving along without any problems. Dust suppression with water cannon to minimize airborne particles during demo continues. A total of nine dumpsters where pulled away from the Site loaded with contaminated demo debris to the landfill for proper disposal. The debris was wetted down with the water cannon before being loaded into the dumpsters and hauled away to the landfill for proper disposal.
14:00-14:30	IH collected air samples and samplers and exited the Site.
18:00-19:30	IH prepared air samples and performed air sample analysis via PCM. All air samples were below 0.01 f/cc.



YOTI N.N. & ASSOCIATES, INC (YNN)
Industrial Hygiene and Environmental Services

AIR SAMPLE DATA SHEET

Client: MCPS **Project Name:** Joann Leleck Elementary School
Work Area: Along the Fence **Date:** 10/25/2024

Sample NO.	Location / Code Relation to work	FLOW RATE		Time		Total Time	Total Volume	Fibers	Fibers CC
		Start	End	On	Off				
102524-1	Environmental-Main Entrance on Fence	3	3	7:12	14:00	408	1224	5	< 0.01
102524-2	Environmental-Facing White Apartments	3	3	7:14	14:02	408	1224	7	< 0.01
102524-3	Environmental-Facing House 705	3	3	7:16	14:05	409	1227	6.5	< 0.01
102524-4	Environmental-Facing Brown Apts.	3	3	7:18	14:08	410	1230	7	< 0.01
102524-5	Environmental-Facing Brown Apts.	3	3	7:19	14:09	410	1230	8.5	< 0.01
102524-6	Environmental-Facing St. Camillus	3	3	7:25	14:15	410	1230	6.5	< 0.01
102524-7	Environmental-Facing St. Camillus	3	3	7:26	14:16	410	1230	5.5	< 0.01
102524-8	Environmental-Facing Playground	3	3	7:28	14:18	410	1230	5	< 0.01
102524-9	Environmental-Facing Playground	3	3	7:29	14:19	410	1230	6	< 0.01
102524-10	Environmental-Facing Gym	3	3	7:32	14:22	410	1230	8	< 0.01
102524-11	Environmental-Facing Gym	3	3	7:33	14:23	410	1230	6.5	< 0.01
102524-12	Environmental-Facing Field	3	3	7:36	14:26	410	1230	8.5	< 0.01
Abbreviations:	PRE - Pre-Abatement Sampling	BLK - Blank		NFO - No Fibers Observed					
	OCBA - Outside Glove Bag Area	IWA - Inside Work Area		Post - Final Clearance monitoring					
	IGBA - Inside Glove Bag Area	OWA - Outside Work Area		AMB - Ambient					
	PRS - Personal Sample	OBT - Outside Barrier Tape		CB - Critical Barrier					
	IBT - Inside Barrier Tape								

Analyst: John Ndanga
Date: 10/25/2024



YOTI N.N. & ASSOCIATES, INC (YNN)
 Industrial Hygiene and Environmental Services

AIR SAMPLE DATA SHEET

Client: MCPS Project Name: Joann Leleck Elementary School
 Work Area: Along the Fence Date: 10/25/2024

Sample NO.	Location / Code Relation to work	FLOW RATE		Time		Total Time	Total Volume	Fibers	Fibers CC	
		Start	End	On	Off					
102524-13	Environmental-Facing Field	3	3	7:37	14:30	413	1239	8	< 0.01	
102524-14	BLK								NFO	
102524-15	BLK								NFO	
Abbreviations:		BLK - Blank						NFO - No Fibers Observed		
		IWA - Inside Work Area						Post - Final Clearance monitoring		
		OWA - Outside Work Area						AMB - Ambient		
		OBT - Outside Barrier Tape						CB - Critical Barrier		
		PRE - Pre-Abatement Sampling								
		OGBA - Outside Glove Bag Area								
		IGBA - Inside Glove Bag Area								
		PRS - Personal Sample								
		IBT - Inside Barrier Tape								

Analyst: John Ndanga Date: 10/25/2024



DAILY LOG SHEET

Date: 10/26/2024

Job Name: Joann Leleck ES

Time	Remarks
7:00	YNN's field IH arrived at Joann Leleck Elementary school (Site) to perform environmental
	(fiber-in-air) sampling following the fire incident which resulted in almost total colaps of the
	structure. The Site is located at 710 Beacon Road in Silver Spring, Maryland.
	The demo Contractor (Bowen & Kron) will continue to separate contaminated debris from scrap
	metal. No truck loading of the debris will be performed today. The support crew will continue to
	wet down the demo debris utilizing the water truck.
7:15	IH calibrated low volume air samplers with a rotameter and commenced environmental air
	sampling along the erected fence surrounding the demolished building structure.
	Air samplers were strategically positioned to capture air quality in different sections of the Site.
	Only one excavator will be working today. Demo of the portable will continue.
	A worker will continue to wet down the debris and surroundings utilizing a water truck with a
	water cannon for dust suppression to minimize airborne particles. No dump trucks today.
10:30	IH performed a walk through of the area and checked on the air samplers. Air samplers were
	were observed running. The excavator operator continues to demo portables.
	Support crew continue to wet down the demo debris and the surroundings. Being another
	windy day, wetting down of the debris and surroundings has been going with more frequency
	to minimize airborne particle and general dust supression.
13:30	IH started collecting air samples and samplers.
14:00	IH completed collecting air samplers and exited the Site.
15:30-17:00	IH prepared air samples and performed air sample analysis via PCM. All air samples were
	below 0.01 f/cc.



YOTI N.N. & ASSOCIATES, INC (YNN)

Industrial Hygiene and Environmental Services

AIR SAMPLE DATA SHEET

Client: MCPS Project Name: Joann Leleck Elementary School
 Work Area: Along the Fence Date: 10/26/2024

Sample NO.	Location / Code Relation to work	FLOW RATE		Time		Total Time	Total Volume	Fibers	Fibers CC
		Start	End	On	Off				
102624-1	Environmental-Main Entrance on Fence	4	4	7:15	13:30	375	1500	6.5	< 0.01
102624-2	Environmental-Facing White Apartments	4	4	7:16	13:31	375	1500	5	< 0.01
102624-3	Environmental-Facing House 705	4	4	7:18	13:33	375	1500	6.5	< 0.01
102624-4	Environmental-Facing Brown Apts.	4	4	7:21	13:36	375	1500	8.5	< 0.01
102624-5	Environmental-Facing Brown Apts.	4	4	7:22	13:37	375	1500	7	< 0.01
102624-6	Environmental-Facing St. Camillus	4	4	7:27	13:44	377	1508	5	< 0.01
102624-7	Environmental-Facing St. Camillus	4	4	7:28	13:45	377	1508	6.5	< 0.01
102624-8	Environmental-Facing Playground	4	4	7:29	13:48	379	1516	4	< 0.01
102624-9	Environmental-Facing Playground	4	4	7:31	13:49	378	1512	5.5	< 0.01
102624-10	Environmental-Facing Gym	4	4	7:34	13:52	378	1512	5.5	< 0.01
102624-11	Environmental-Facing Gym	4	4	7:35	13:53	378	1512	7	< 0.01
102624-12	Environmental-Facing Field	4	4	7:37	13:56	379	1516	5	< 0.01
Abbreviations:									
	PRE - Pre-Abatement Sampling	BLK - Blank		NFO - No Fibers Observed					
	OGBA - Outside Glove Bag Area	IWA - Inside Work Area		Post - Final Clearance monitoring					
	IGBA - Inside Glove Bag Area	OWA - Outside Work Area		AMB - Ambient					
	PRS - Personal Sample	OBT - Outside Barrier Tape		CB - Critical Barrier					
	IBT - Inside Barrier Tape								

Analyst: John Ndanga
 Date: 10/26/2024



AIR SAMPLE DATA SHEET

Client: MCPS **Project Name:** Joann Leleck Elementary School
Work Area: Along the Fence **Date:** 10/26/2024

Sample NO.	Location / Code Relation to work	FLOW RATE		Time		Total Time	Total Volume	Fibers	Fibers CC
		Start	End	On	Off				
102624-13	Environmental-Facing Field	4	4	7:52	13:58	366	1464	5.5	< 0.01
102624-14	BLK								NFO
102624-15	BLK								NFO
Abbreviations: PRE - Pre-Abatement Sampling OGBA - Outside Glove Bag Area IGBA - Inside Glove Bag Area PRS - Personal Sample IBT - Inside Barrier Tape BLK - Blank IWA - Inside Work Area OWA - Outside Work Area OBT - Outside Barrier Tape NFO - No Fibers Observed Post - Final Clearance monitoring AMB - Ambient CB - Critical Barrier									

Analyst: John Ndanga
Date: 10/26/2024



YOTI N.N. & ASSOCIATES, INC (YNN)

Industrial Hygiene and Environmental Services

AIR SAMPLE DATA SHEET

Client: MCPS Project Name: Joann Leleck Elementary School
 Work Area: Along the Fence Date: 10/27/2024

Sample NO.	Location / Code Relation to work	FLOW RATE		Time		Total Volume	Fibers	Fibers CC
		Start	End	On	Off			
102724-1	Environmental-Main Entrance on Fence	4	4	7:20	13:00	1360	4	< 0.01
102724-2	Environmental-Facing White Apartments	4	4	7:21	13:01	1360	5	< 0.01
102724-3	Environmental-Facing House 705	4	4	7:23	13:04	1364	3	< 0.01
102724-4	Environmental-Facing Brown Apts.	4	4	7:26	13:07	1364	5.5	< 0.01
102724-5	Environmental-Facing Brown Apts.	4	4	7:28	13:08	1360	4.5	< 0.01
102724-6	Environmental-Facing St. Camillus	4	4	7:35	13:15	1360	3	< 0.01
102724-7	Environmental-Facing St. Camillus	4	4	7:36	13:16	1360	3.5	< 0.01
102724-8	Environmental-Facing Playground	4	4	7:38	13:18	1360	2.5	< 0.01
102724-9	Environmental-Facing Playground	4	4	7:39	13:19	1360	3.5	< 0.01
102724-10	Environmental-Facing Gym	4	4	7:41	13:22	1364	3	< 0.01
102724-11	Environmental-Facing Gym	4	4	7:44	13:24	1360	3.5	< 0.01
102724-12	Environmental-Facing Field	4	4	7:52	13:30	1352	6.5	< 0.01
Abbreviations:		BLK - Blank				NFO - No Fibers Observed		
PRE - Pre-Abatement Sampling		IWA - Inside Work Area				Post - Final Clearance monitoring		
OGBA - Outside Glove Bag Area		OWA - Outside Work Area				AMB - Ambient		
IGBA - Inside Glove Bag Area		OBT - Outside Barrier Tape				CB - Critical Barrier		
PRS - Personal Sample								
IBT - Inside Barrier Tape								

Analyst: John Ndanga
 Date: 10/27/2024



AIR SAMPLE DATA SHEET

Client: MCPS **Project Name:** Joann Leleck Elementary School
Work Area: Along the Fence **Date:** 10/27/2024

Sample NO.	Location / Code Relation to work	FLOW RATE		Time		Total Time	Total Volume	Fibers	Fibers CC
		Start	End	On	Off				
102724-13	Environmental-Facing Field	4	4	7:46	13:27	341	1364	3	< 0.01
102724-14	BLK								NFO
102724-15	BLK								NFO

Abbreviations:

PRE - Pre-Abatement Sampling	BLK - Blank	NFO - No Fibers Observed
OGBA - Outside Glove Bag Area	IWA - Inside Work Area	Post - Final Clearance monitoring
IGBA - Inside Glove Bag Area	OWA - Outside Work Area	AMB - Ambient
PRS - Personal Sample	OBT - Outside Barrier Tape	CB - Critical Barrier
IBT - Inside Barrier Tape		

Analyst: John Ndanga
Date: 10/27/2024

Field

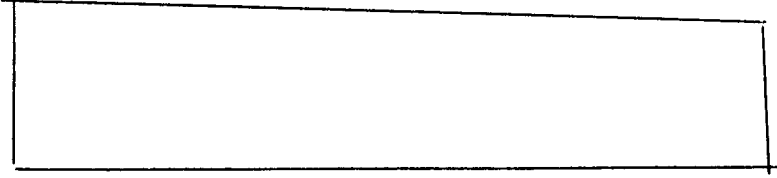

Playground

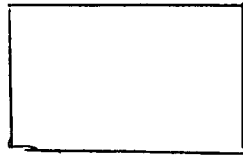

Fence

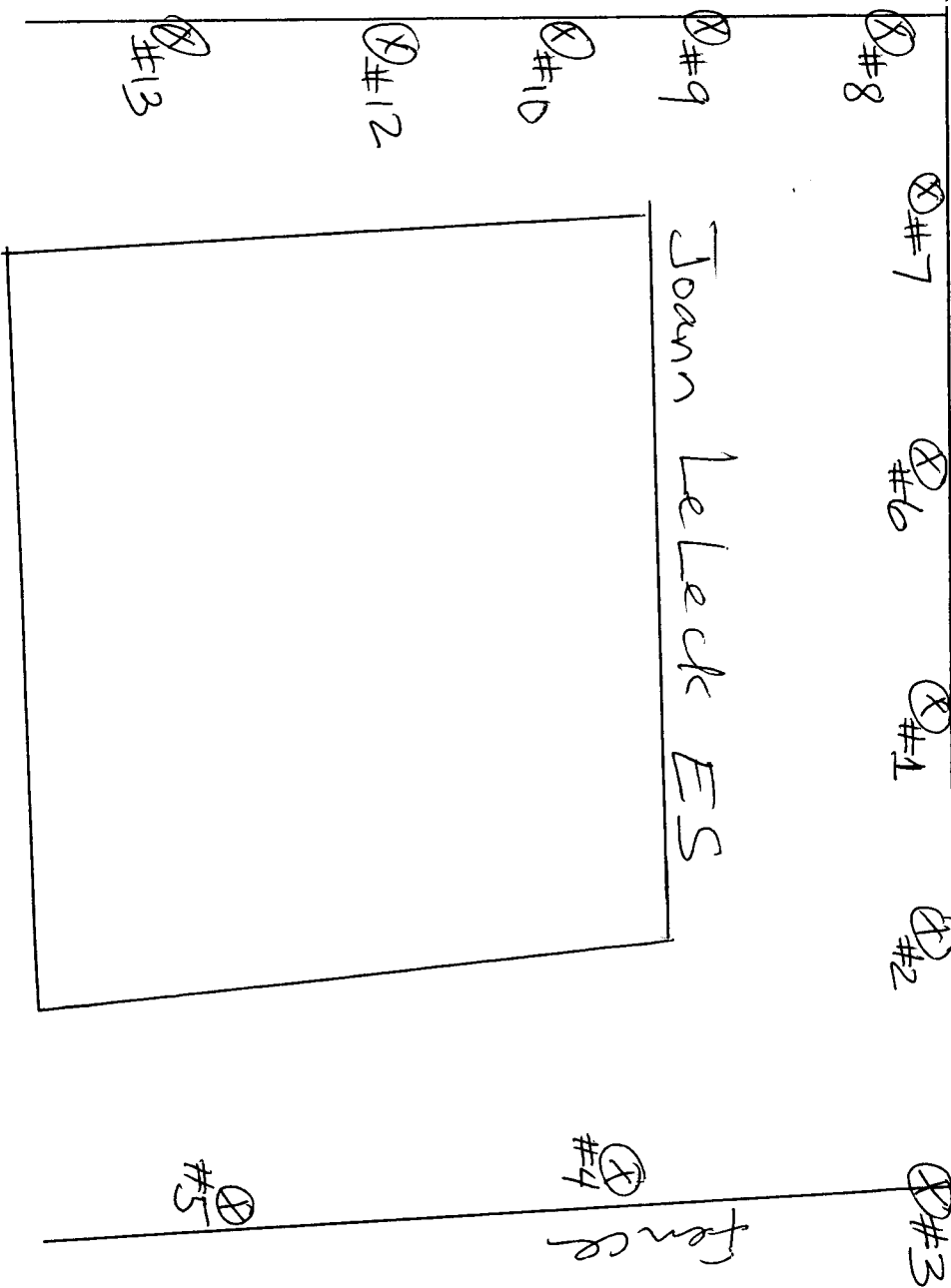

St. Camillus School

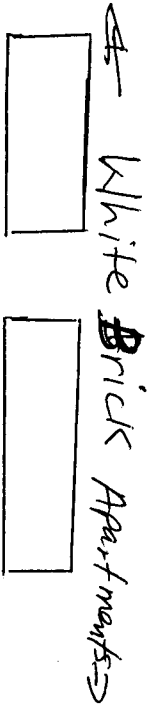

House #705

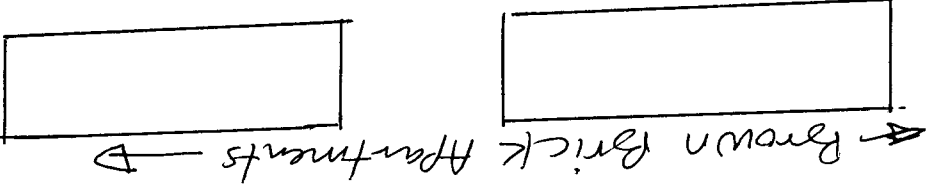

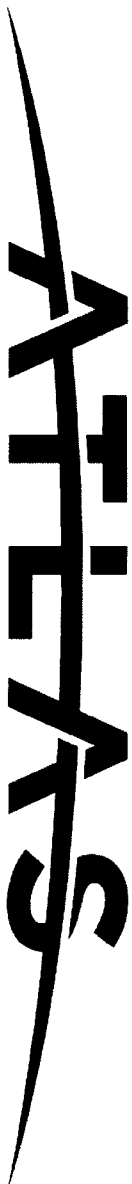

Approval No.: 21 13 01

Certificate of Achievement

Awarded to

John Ndanga

In recognition of successful completion of the course entitled

ASBESTOS ABATEMENT SUPERVISOR REVIEW

An 8-Hour annual refresher program of study presented in accordance with the provisions of the U.S Environmental Protection Agency Model Accreditation Plan 40 CFR Part 763, Appendix C to SUBPART E, for Accreditation under TSCA Title II



Location: Columbia, MD

Clayton E. Miller Course Instructor

November 18, 2023

Examination Date

November 18, 2024

Expiration Date

Course Date

9231 Rumsey Road Columbia, Maryland 21045 410-381-0232 Office 410-423-9235 Direct

Carla M. Gomez Course Director

23-1103

Certificate Number

November 18, 2023

THE
DEEP SOUTH CENTER FOR OCCUPATIONAL
HEALTH AND SAFETY

CERTIFIES THAT

John Ndanga

HAS SATISFACTORILY COMPLETED

Sampling and Evaluating Airborne Asbestos Dust—NIOSH 582
Birmingham, Alabama
November 9-12, 1987

AND IS HEREBY AWARDED THIS CERTIFICATE

PROGRAM DIRECTOR



The Deep South Center for
OCCUPATIONAL
HEALTH & SAFETY

A NIOSH-Supported Educational Resource Center
University of Alabama at Birmingham & Auburn University

COURSE INSTRUCTOR

